

# North Dover Elementary School

Dover, Delaware

Architect: Becker Morgan Moore Olds & Richter, Inc.



Photo Courtesy of Wayne Lyons

for group activities and a variety of teaching opportunities. Most importantly, the commons activity/resource room captures "unprogrammed" space from the corridor and gives it to the educator, resulting in a powerful, yet economical way to respond to the ever critical need for additional teaching space without impacting the project budget.

The school is designed for K-through 5. For expansion the school's master plan calls for a future third classroom pod in between the two main classroom pods, incorporating an interior courtyard adjacent to the present media center. The

## MANUFACTURERS/SUPPLIERS

**Exterior Walls** — CMU: New Holland; Aluminum Entrance & Storefront:

**EFCO Corporation**; Fixed Aluminum Window Frames: TRACO.

**Roof** — Single Ply: Carlisle Syntec; Shingles: Certainteed;

Skylights/Canopies: Kalwall.

**Floors** — Ceramic Tile: Dal-Tile; VCT: Armstrong, Tarkett; Carpet: Blue Ridge; Wood: Superior Floor.

**Interior Walls** — Ceramic Tile: Dal Tile; Glazed Tile: **SpectraGlaze®**;

Operable Partitions: **Panelfold**;

Toilet Partitions: Capitol Partitions;

Lighting: Lithonia.

Glazed Tile: **SpectraGlaze® International**.

The new North Dover Elementary School is a 39,172-square-foot structure designed for 420 students. The primary feature is blue glazed CMU wall which acts as the circulation spine of the facility, linking the public areas of the school and extending outward to welcome students, faculty, and visitors. The main corridor is animated by the use of natural light and colorful primary forms to mark thresholds to important areas of the building. These primary forms and colors link with the blue wall and reinforce the fundamental nature of elementary education by creating spaces and environments that are exciting and interesting for children and enhance the learning process. Two sets of eight classrooms are clustered around open, light-filled "commons" activity/resource areas that allow





building's program limited the normal square footage needed for a full gymnasium, an auditorium and a separate cafeteria. Therefore, the school district opted for a combined gymnasium and "cafetorium." To upscale the "cafetorium" a suspended acoustical cloud system was created over the dining area along with the introduction of multi-color vinyl tile floor patterns. The "cafetorium" and gymnasium can be used in combination or separated by folding partitions. The school district elected to have two different floor finishes in each area. One being a standard wooden floor in the gym and the other being vinyl tile in the "cafetorium". The "cafetorium" is also served by a raised stage area.

The school's vibrant color scheme echoes the primary colors red, yellow and blue in an architectural play utilizing squares, circles, and triangles to boldly define major features and accents within the school. Each pod is entered through a bright red circle, yellow square or green triangle unified with a central blue circulation spine. The same brilliant colors were sprinkled throughout the schools' vinyl flooring, cabinetry, toilet rooms, and light fixtures.

The site was developed with two separate circulation loops, one for the parents/student drop-off, and a second school bus drop-off. Both circulation loops abut a common unloading walkway with provisions for a future outdoor canopy to be extended from the main entrance. The site was fully developed with a stormwater pond, outdoor play areas, softball fields, soccer field, general open space and perimeter access of the building for emergency equipment.

- LEGEND
1. ART / MUSIC
  2. CLASSROOM
  3. COMMONS
  4. COMMA / TECH
  5. MEDIA CENTER
  6. COMPUTER LAB
  7. KINDERGARTEN
  8. FACULTY ROOM
  9. LOBBY
  10. ADMINISTRATION
  11. HEALTH
  12. STAGE
  13. CAFETERIA
  14. KITCHEN
  15. GYMNASIUM
  16. MECHANICAL

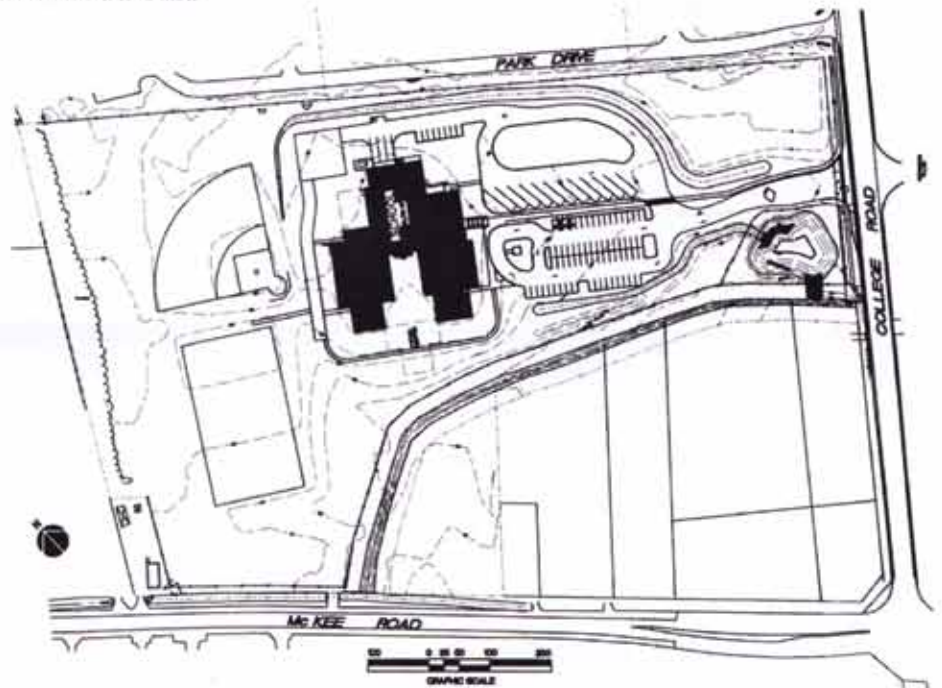
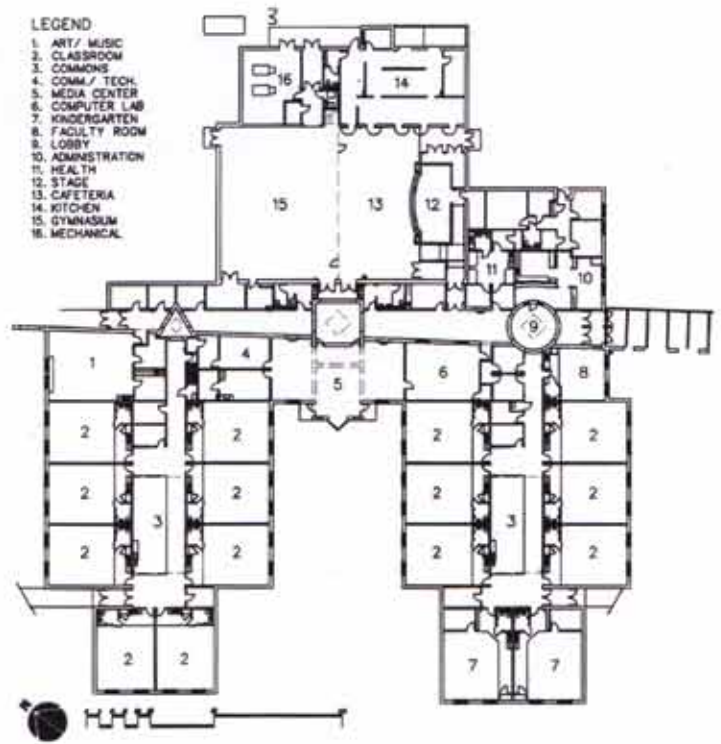



## ARCHITECT

BECKER MORGAN MOORE OLDS & RICHTER, INC.  
738 South Governors Avenue  
Dover, DE 19903

## FILE UNDER

EDUCATIONAL  
Dover, Delaware

### CONSTRUCTION TEAM

**ASSOCIATE ARCHITECT: Grimm & Parker**

11785 Beltsville Drive, Calverton, MD 20705

**GENERAL CONTRACTOR: Richard Y. Johnson & Son, Inc.**

P.O. Box 105, Lincoln, DE 19960

**STRUCTURAL ENGINEER: Gredell & Associates**

8 The Green, Dover, DE 19901

**ELECTRICAL & MECHANICAL ENGINEER: D. Brooks Cross**

8475 Old Marlboro Road, Upper Marlboro, MD 20722

**LANDSCAPE ARCHITECT:**

Landscape Architectural Services

P.O. Box 293, Dover, DE 19903

**COST ESTIMATOR:**

Becker Morgan Moore Olds & Richter, Inc.

738 South Governors Avenue, Dover, DE 19903

**EXTERIOR WALLS:** Concrete block cavity.

**ROOF:** Single ply ballasted, shingles.

**FLOORS:** Concrete.

**INTERIOR WALLS:** Concrete, glazed block, drywall.

### GENERAL DESCRIPTION

**SITE:** 17.66 acres, 7,692,696 square feet.

**NUMBER OF BUILDINGS:** One; 18 classrooms, cafeteria/ gym combination.

**BUILDING SIZES:** First floor, 39,172; total, 39,172 square feet.

**BUILDING HEIGHT:** 33' max at gym.

**BASIC CONSTRUCTION TYPE:** BOCA 2-C/New.

**FOUNDATION:** Reinforced concrete footings, concrete block foundation walls.



## NORTH DOVER ELEMENTARY SCHOOL

**Date Bid: May 1995 • Construction Period: June 1996 to Sep 1996 • Total Square Feet: 39,172**

C.S.I. Divisions (1 through 16)	COST	% OF COST	SQ.FT. COST	SPECIFICATIONS
BIDDING REQUIREMENTS	88,075	2.62	2.25	Bonds & certificates, general conditions.
1. GENERAL REQUIREMENTS	79,735	2.37	2.04	1 Field engineering, construction facilities & temporary controls.
3. CONCRETE	171,417	5.09	4.38	3 —
4. MASONRY	585,552	17.40	14.95	4 —
5. METALS	225,012	6.69	5.74	5 —
6. WOOD & PLASTICS	98,101	2.92	2.51	6 —
7. THERMAL & MOIST. PROTECT	187,625	5.58	4.79	7 Insulation, EIFS, shingles & roof tiles, membrane roofing, flashing & sheet metal, skylights, joint sealers.
8. DOORS & WINDOWS	153,978	4.58	3.93	8 Metal doors & frames, wood & plastic doors, special doors, entrances & storefronts, metal windows, hardware, glazing.
9. FINISHES	244,385	7.26	6.24	9 Lath & plaster, tile, acoustical treatment, wood flooring, resilient flooring, painting.
10. SPECIALTIES	87,732	2.61	2.24	10 Visual display board, compartments & cubicles, louvers & vents, grilles & screens, flagpoles, identifying devices, lockers, fire protection, operable partitions, storage shelving, toilet & bath accessories.
11. EQUIPMENT	201,155	5.98	5.13	11 Teller & service, theatre & stage, audio-visual, food service, athletic, recreational & therapeutic.
12. FURNISHING	42,930	1.28	1.09	12 Manufacturing casework, window treatment.
13. SPECIAL CONSTRUCTIONS	—	—	—	13 —
14. CONVEYING SYSTEMS	—	—	—	14 —
15. MECHANICAL	818,718	24.33	20.90	15 —
16. ELECTRICAL	380,074	11.29	9.70	16 —
<b>TOTAL BUILDING COST</b>	<b>3,364,489</b>	<b>100%</b>	<b>\$85.89</b>	
2. SITE WORK	553,076			2 —
LANDSCAPING & OFFSITE WORK	—			—
<b>TOTAL PROJECT COST</b>	<b>3,917,565</b>			

*(Excluding architectural and engineering fees)*

**UPDATED ESTIMATE TO APRIL 1999: \$94.69 PER SQUARE FOOT**