

CM Architecture

A PICTORIAL PUBLICATION OF THE NATIONAL CONCRETE MASONRY ASSOCIATION

HOUSES

constructed
with

Spectra Glaze Block



PRIVATE RESIDENCE

Phoenix-area, Arizona

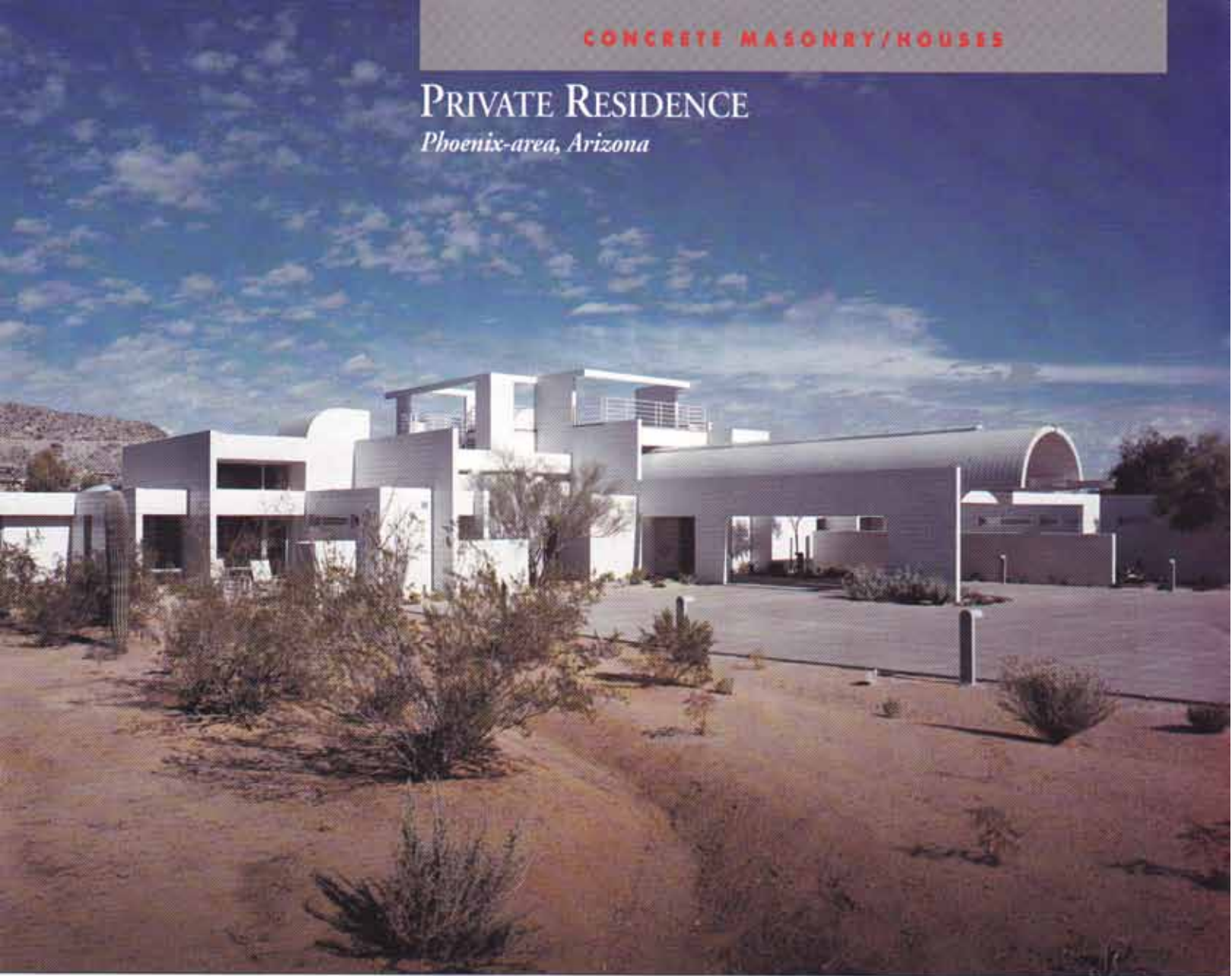

The pristine white residence stands as artistic expression, surrounded by a harsh natural beauty. See cover.

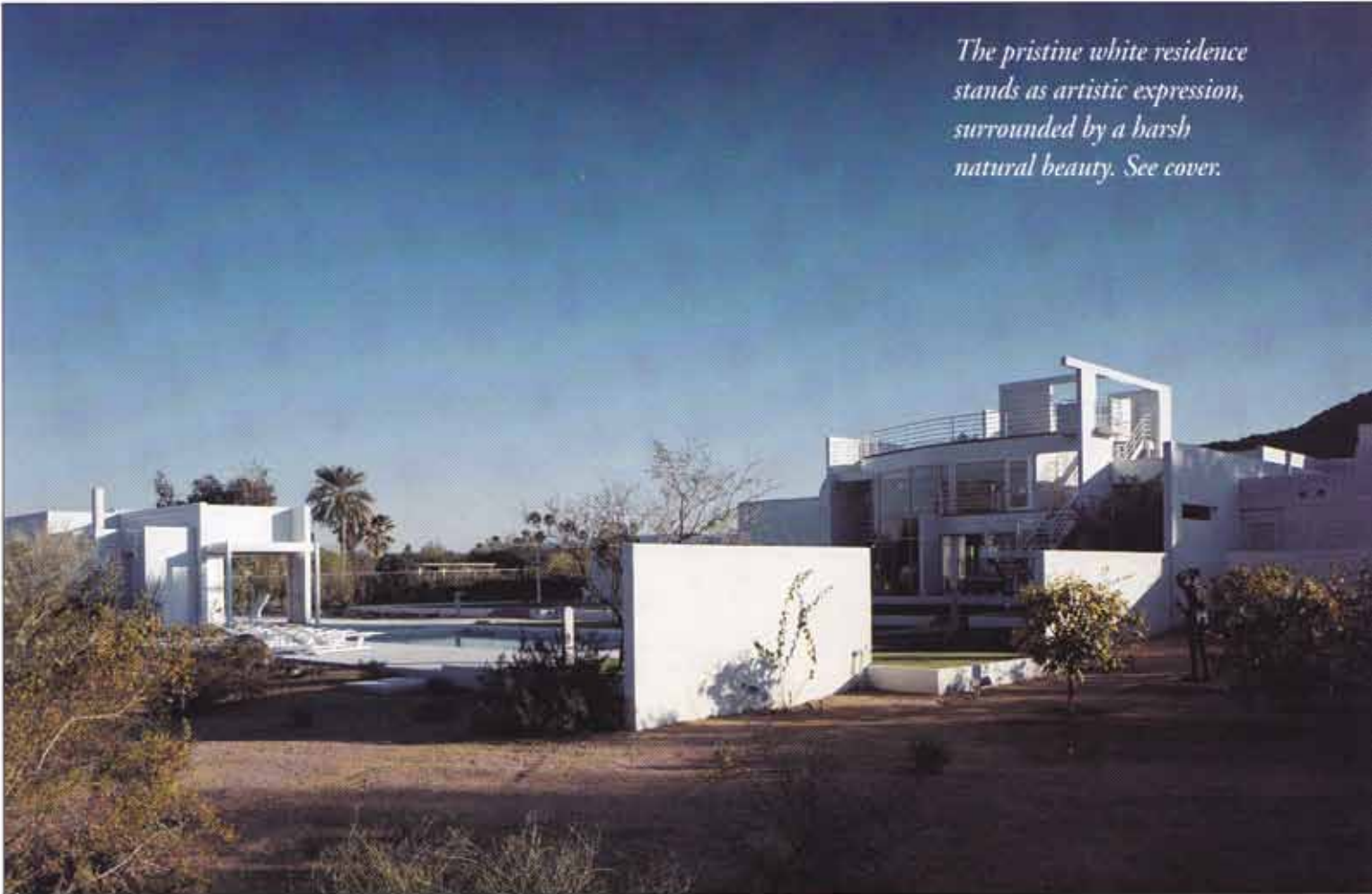

In a secluded desert setting with inspiring mountain views sits this dramatic residence.

With white-glazed masonry walls, a barrel-vaulted entry promenade, and rooftop decks, its structured beauty stands in sharp contrast to the natural environs. Yet somehow the two do not clash, but instead pleasingly acknowledge one another.

The axial floorplan is centered on an expansive gallery area for the owners' contemporary art collection. Master bedroom suite on one side and support services on the other flank the axial portion, leading to a main section with large public spaces and more private, interior areas.

Architect Douglas B. Sydnor created a residence in all white, borrowing from the Arizona vernacular. The light color reduces cooling loads.

A four-car garage, satellite kitchen, and dressing pavilion are included at the swimming pool area. An expansive entry court features a fountain and a staging area for displaying exterior sculpture. **CM**

*Project Data: Private Residence
Project Architect: Douglas Sydnor
Architect and Associates
Project Size: 7,500 square feet
Construction: Reinforced concrete
masonry structure with wood joist and
steel roof.*

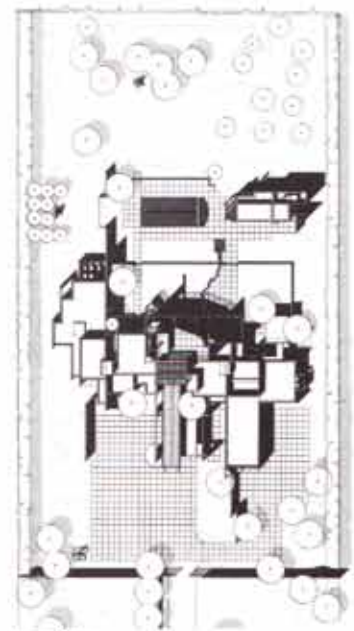

SITE PLAN